

Map of the

# STRAFFORD TOWN FOREST

Strafford, New Hampshire

689.9± acres

*Showing Trails, Stone walls and Wildland Reserve*

MAP SCALE:



1 inch = 1320± feet

## MAP LEGEND

- Property line
- - - Trail
- ○ Stonewall
- \* - Barbed wire
- ~ Tree line
- \* Beaver swamp
- · - Wildland Reserve

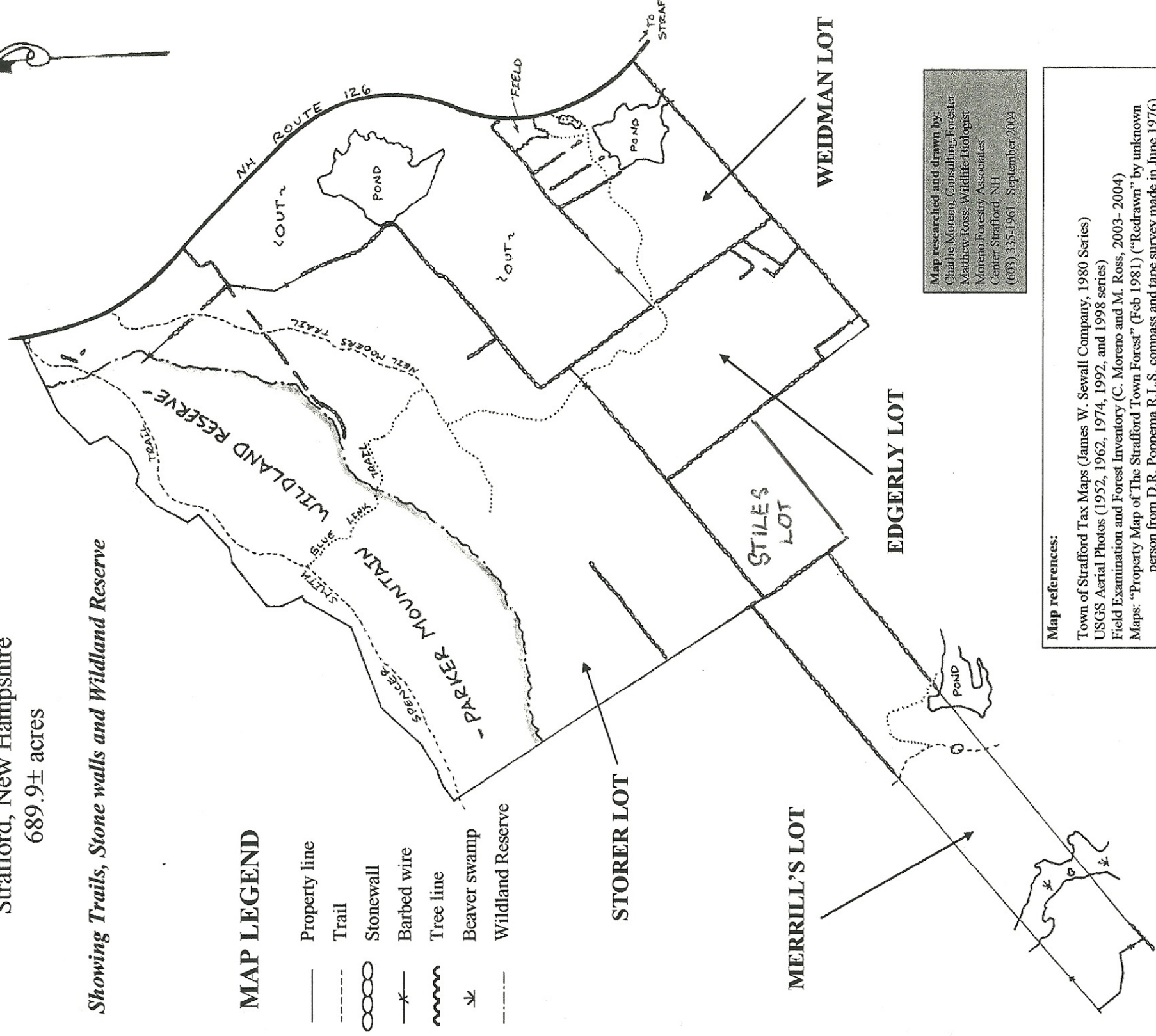

Map researched and drawn by:  
 Charlie Moreno, Consulting Forester  
 Matthew Ross, Wildlife Biologist  
 Moreno Forestry Associates  
 Center Strafford, NH  
 (603) 335-1961 September 2004

### Map references:

- Town of Strafford Tax Maps (James W. Sewall Company, 1980 Series)
- USGS Aerial Photos (1952, 1962, 1974, 1992, and 1998 series)
- Field Examination and Forest Inventory (C. Moreno and M. Ross, 2003-2004)
- Maps: "Property Map of The Strafford Town Forest" (Feb 1981) ("Redrawn" by unknown person from D.R. Poppema R.L.S. compass and tape survey made in June 1976)