

PLAN REFERENCES:

- "PLAN OF LAND, CUSHMAN C. & DOROTHY A. MORSE, BOW LAKE, STRAFFORD, NEW HAMPSHIRE" BY: G.L. DAVIS DATED: MARCH 1954 S.C.R.D. POCKET 7, FOLDER 1, PLAN #11
- "LAND OF LYNN & DONNA DARNELL, LAKESHORE DRIVE, BOW LAKE, STRAFFORD, N.H." BY: BERRY SURVEYING & ENGINEERING DATED: OCTOBER 1, 1997 FILE NO. DB 1997-60 S.C.R.D. PLAN #55-77
- "BOUNDARY SURVEY FOR KRISTINE E. TULLY, LAKESHORE DRIVE, STRAFFORD, N.H., TAX MAP 35, LOT 10-1" BY: BERRY SURVEYING & ENGINEERING DATED: AUGUST 14, 2013 FILE NO. DB 2013-077 S.C.R.D. PLAN #107-83
- "PROPOSED LOT LINE REVISION, BLANCA M. DINEEN 1996 TRUST AND ROBERT WILCOX, LAKESHORE DRIVE, STRAFFORD, N.H." BY: BERRY SURVEYING & ENGINEERING DATED: NOVEMBER 14, 2000 FILE NO. DB 2000-147 S.C.R.D. PLAN #61-34

PLAN REFERENCES:

- "SUBDIVISION PLAN PIONEER SHORES, BOW LAKE, STRAFFORD, N.H., OWNER ROBERT T. BENNETT; BY: FREDERICK E. DREW ASSOCIATES DATED: OCTOBER, 1980 S.C.R.D. PLAN #21A-21
- "BOUNDARY PLAN LAND OF KRJ FINANCE LLC, PRINCESS PINE ROAD, STRAFFORD, N.H., TAX MAP 35, LOT 1" BY: BERRY SURVEYING & ENGINEERING DATED: JUNE 8, 2021 FILE NO.: DB 2020-120 NOT RECORDED
- "BOUNDARY PLAN LAND OF WILLIAM F. & DIANA C. KEENAN, 64 LAKESHORE DRIVE, STRAFFORD, N.H., TAX MAP 35, LOT 8" BY: BERRY SURVEYING & ENGINEERING DATED: APRIL 14, 2023 FILE NO.: DB 2023-030

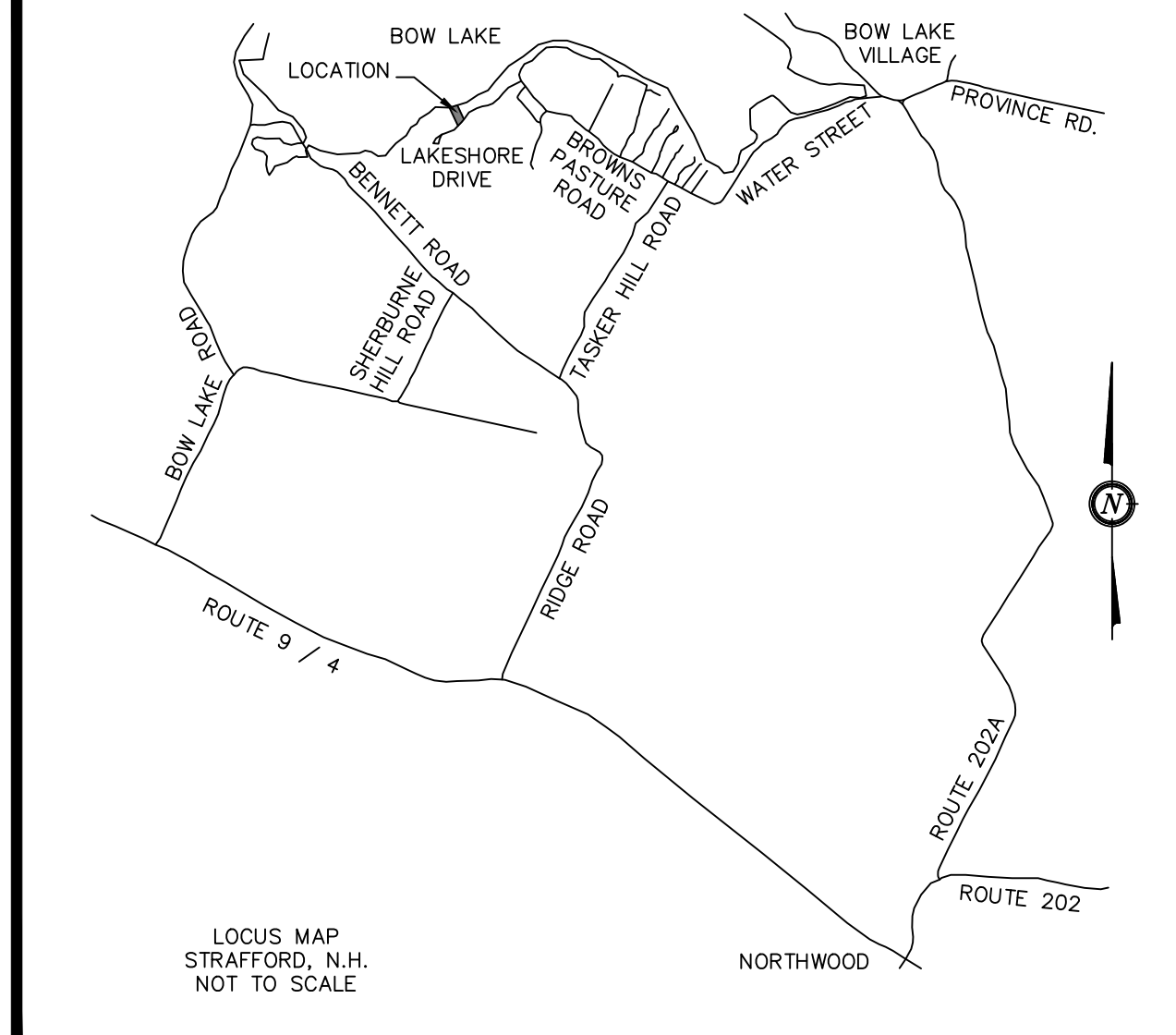

NOTES:

- OWNER: HARTMANN FAMILY REVOCABLE TRUST SAMUEL B. & LINDA J. HARTMANN, TRUSTEES P.O. BOX 89 STRAFFORD, NH 03884
- TAX MAP 35, LOT 8
- LOT AREA: 33,000 Sq. Ft.±, 0.75 Ac.±
- S.C.R.D. BOOK 5125, PAGE 544
- ZONING: AGRICULTURAL-RESIDENTIAL DISTRICT FRONT SETBACK: 40.0' SIDE SETBACK: 25.0' REAR SETBACK: 25.0' SEPTIC SYSTEM TO LAKE SETBACK: 100.0'
- I HEREBY CERTIFY THAT, TO THE BEST OF MY KNOWLEDGE & BELIEF, THIS PARCEL DOES FALL WITHIN THE FLOOD PLAIN FLOOD HAZARD REF.: FEMA COMMUNITY# 330196, MAP# 33017C0260D, DATED: MAY 17, 2005, ZONE AE ELEV. 517
- VERTICAL DATUM BASED ON USGS NAVD88 ELEVATIONS. HORIZONTAL COORDINATES BASED ON NAD83. COORDINATES GATHERED USING TOPCON HIPER SR SURVEY GRADE GPS RECEIVERS PER PLN REF. #6
- THE INTENT OF THIS PLAN IS TO SHOW A DETAIL VIEW OF THE PROPOSED CONDITIONS OF TAX MAP 35, LOT 8 IN RELATION TO A VARIANCE APPLICATION.

N/F THE JAMES K. STEVENS REVOCABLE TRUST OF 2015 STEVENS, JAMES K. & LYNNE A., TRUSTEES 12 JO LENS DRIVE YORK, ME 03909 TAX MAP 35, LOT 7 S.C.R.D. BOOK 5060, PAGE 784 PLAN REF #1 & #2

N/F FRANK A. BYRON REVOCABLE TRUST BYRON, FRANK A., TRUSTEE 8 MALLARD COURT LITCHFIELD, NH 03052 TAX MAP 35, LOT 9 S.C.R.D. BOOK 2250, PAGE 494 PLAN REF #1

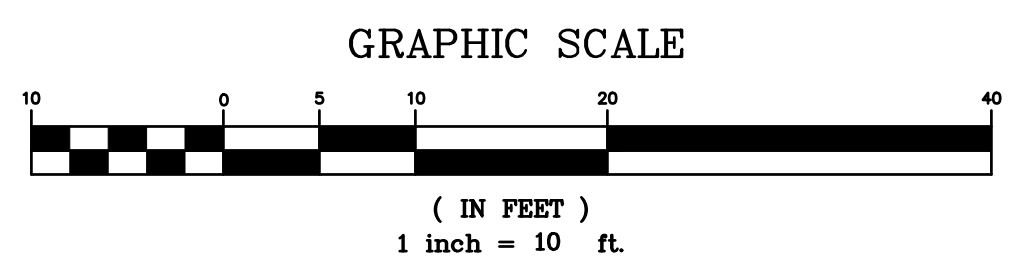

LEGEND:

- STEEL STAKE
- IRON BOUND/REBAR
- UTILITY POLE/GUY WIRE
- PHOTO POINT
- PROPERTY LINE
- BENCHMARK
- TREES
- 50' NHDES
- 150' NHDES
- 50' PRIMARY BUILDING SETBACK LINE (NHDES/TOWN)
- 150' NATURAL WOODLAND BUFFER LINE (NHDES)
- REFERENCE LINE
- TREELINE
- BUILDING SETBACK LINE
- FND FOUND
- TYP TYPICAL
- S.C.R.D. STRAFFORD COUNTY REGISTRY OF DEEDS

| REVISION | DATE | DESCRIPTION |
|--|------|-------------|
| VARIANCE PLAN LAND OF HARTMANN FAMILY REVOCABLE TRUST 64 LAKESHORE DRIVE STRAFFORD, N.H. TAX MAP 35, LOT 8 | | |
| BERRY SURVEYING & ENGINEERING 335 SECOND CROWN POINT RD. BARRINGTON, N.H. (603)332-2863 SCALE : 1 IN. EQUALS 10 FT. DATE : JANUARY 25, 2024 FILE NO. : DB 2023-030 | | |